

S P E C I F I C A T I O N S

MODEL	LX31	LX41	LX50
WORKING HEIGHT A	11.5m	14.3m	17.0m
MAX. PLATFORM HEIGHT B	9.44m	12.34m	15.09m
MIN. PLATFORM HEIGHT C	1.64m	1.87m	1.93m
MAX.PLATFORM CAPACITY - without roll out deck	907kg	680kg	454kg
PLATFORM CAPACITY - with roll out deck	680kg	567kg	340kg
PLATFORM SIZE	1.78m x 3.65m	1.78m x 3.65m	1.78m x 3.65m
PLATFORM SIZE - with dual decks extended	1.73m x 5.8m	1.73m x 5.8m	1.73m x 5.8m
OVERALL WIDTH F	2.29m	2.29m	2.29m
OVERALL LENGTH - deck in D	4.08m	4.08m	4.08m
OVERALL LENGTH - single deck extended G	5.2m	5.2m	5.2m
OVERALL LENGTH - dual decks extended H	5.8m	5.8m	5.8m
OVERALL HEIGHT - guardrails up E	2.53m	2.76m	3.00m
HEIGHT - guardrails lowered	1.64m	1.87m	2.10m
INSIDE TURNING RADIUS	1.2m	1.2m	1.2m
GRADEABILITY - 2 wheel drive	30%	30%	30%
GRADEABILITY - 4 wheel drive	35%	35%	35% (24% dual deck)
DRIVE SPEED - lowered	0 - 5.0km/h	0 - 5.0km/h	0 - 5.0km/h
DRIVE SPEED - elevated	0 - 0.48km/h	0 - 0.48km/h	0 - 0.48km/h
LIFT SPEED TO MAX. HEIGHT	50 seconds	50 seconds	80 seconds
LOWER SPEED FROM MAX. HEIGHT	48 seconds	48 seconds	75 seconds
BATTERIES - electric/bi-energy	8x6V, 350AH	8x6V, 350AH	n/a
ENGINE - bi-energy	Kubota ZB600	Kubota ZB600	n/a
- diesel	Kubota D905 water cooled	Kubota D905 water cooled	Kubota D905 water cooled
TYRES	10 x 16.5 NHS 8ply/air	10 x 16.5 NHS 8ply/air	10 x 16.5 NHS 8ply/poly filled
TOEBOARDS	150mm	150mm	150mm
WEIGHT SECTION:			
Electric 2WD	4,428kg	5,149kg	n/a
Bi-Energy 2WD	4,586kg	5,308kg	n/a
Diesel 2WD	4,155kg	4,877kg	5,648kg
Diesel 4WD RT	4,278kg	4,999kg	5,770kg
Additional weight of single deck extension	222kg	222kg	222kg
Additional weight of dual deck extensions	553kg	553kg	553kg
Additional weight of outriggers/weldments	318kg	318kg	318kg

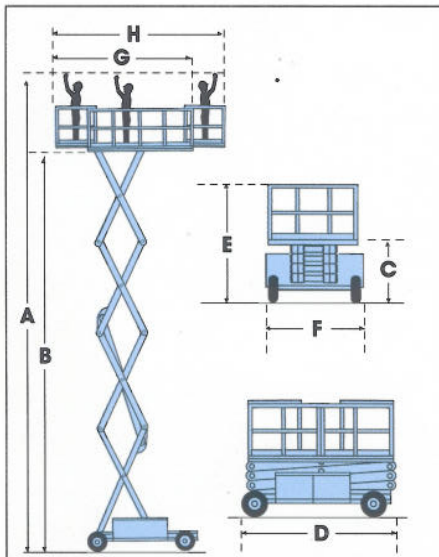

STANDARD FEATURES

- Diesel, Electric or Bi-Energy power
- Proportional joystick control
- Oscillating front axle on 4WD models
- Easy access service modules
- Weatherproof electrical enclosure
- Quick-fold guardrails
- Multiple disc, dual wheel parking brake
- Descent alarm
- Tilt alarm

OPTIONAL EXTRAS

- Single or dual deck extensions
- Hydraulic levelling jacks (4) on Diesel models only (standard on LX50 dual deck)
- Poly-filled tyres (LX31 and LX41)
- Horn
- Motion alarm (forward/reverse)
- Exhaust scrubber
- Gasoline /dual fuel engine
- Removable controller

Specifications subject to change without notice. Photos and diagrams in this brochure are for promotional purposes only. Refer to appropriate UpRight Operator's manual for detailed instructions on the proper use and maintenance of this equipment. UpRight also manufacture a complete line of scaffolding and other aerial work platforms. Contact your UpRight distributor for information on other products.

CE This product is available with the CE mark confirming compliance with all relevant European Machinery Directives

MANUFACTURED BY

UpRight

UpRight

UpRight International Marketing bv.

Hong Kong Straat 61-63

3047 BR Rotterdam

The Netherlands

Tel: +31 10 238 0000 Fax: +31 10 238 0001

www.upright.com

email: info@uprighteuro.com